

Connected in Series

WARNING:
This LED Strip Light can be connected in series. Max 10pcs for 4ft, or 5pcs for 8ft.Connect wires as shown in wiring diagram.

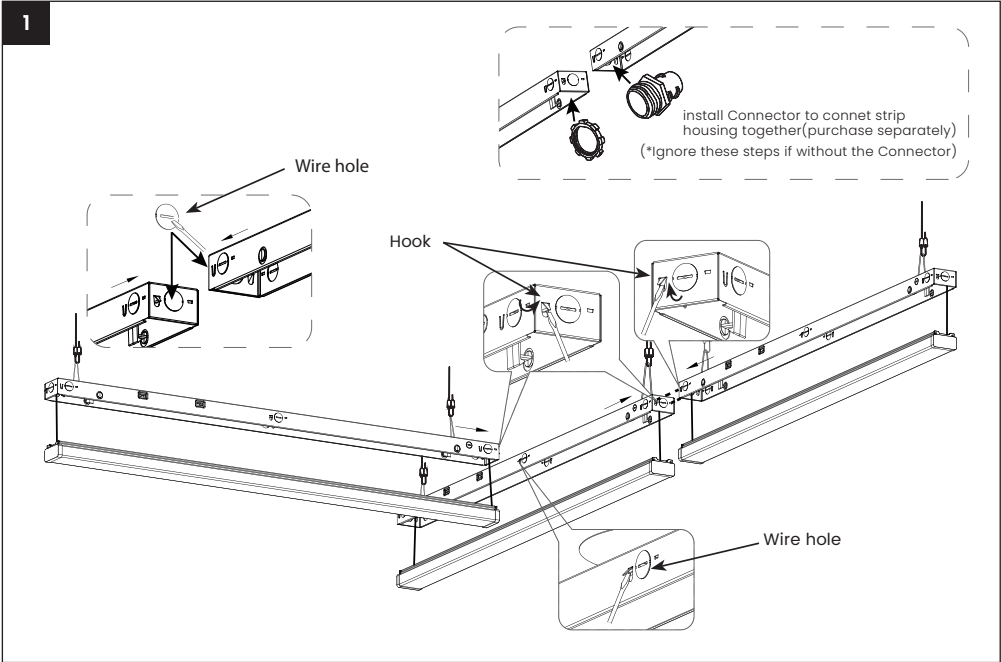

Use a screwdriver to pry open the Hook and open the Wire hole. Insert the hook into the hole in the direction of the arrow.

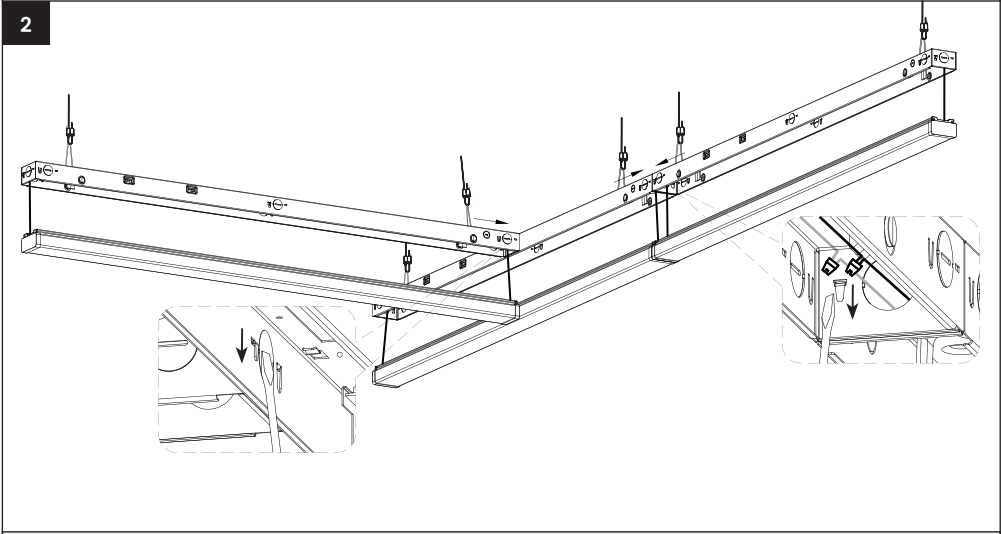

Reset the hook with screwdriver, to make sure the lamps are securely connected.

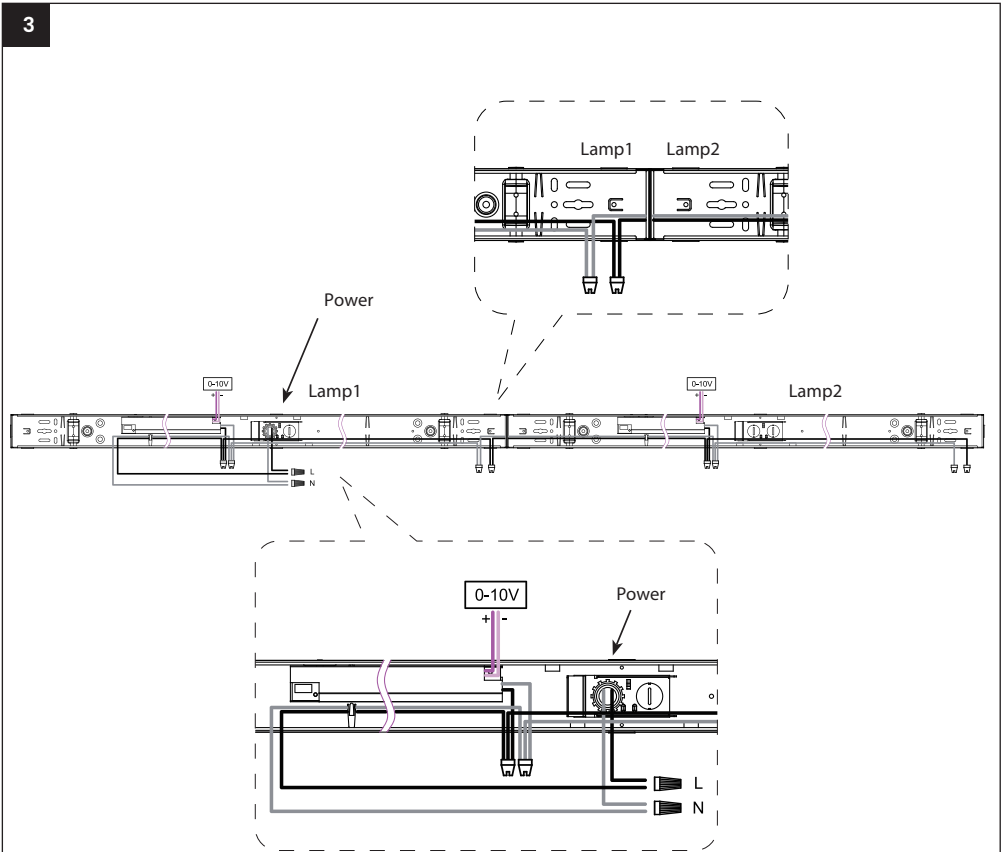

Make electrical connections.

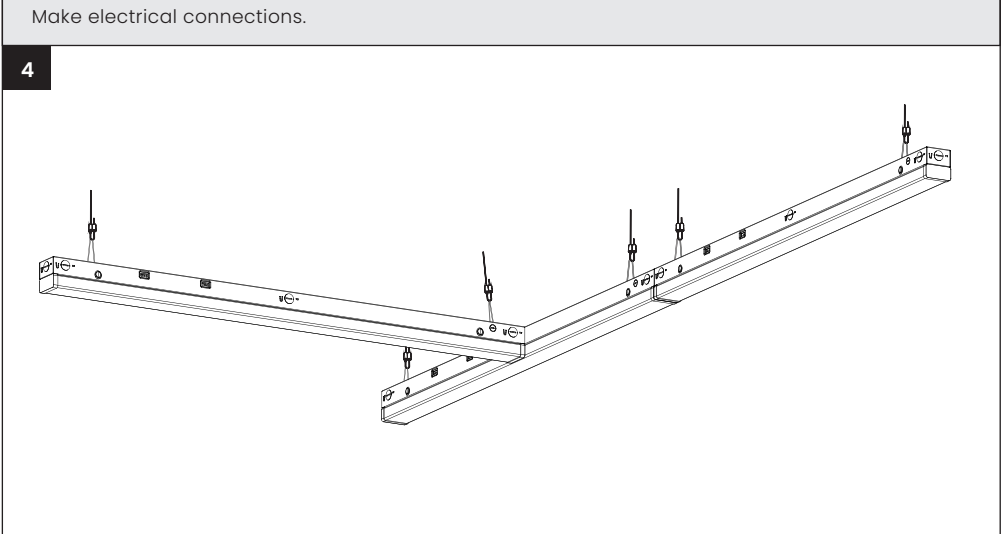

Connect multiple fixtures together Create a variety of shapes.

LED LINEAR STRIP LIGHT INSTALLATION INSTRUCTIONS

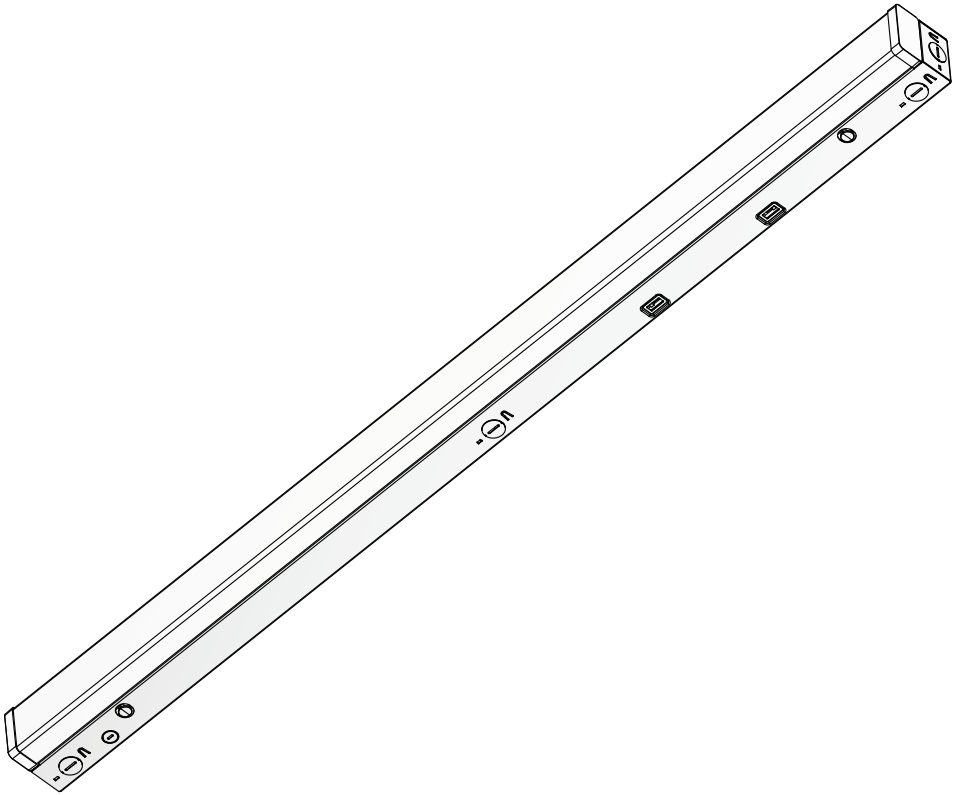

SAFETY INSTRUCTION :

Basic safety precautions should always be followed when installing,including the following:

- 1. Read instructions carefully before installing.
- 2. This Strip Light requires professional installation and maintenance.
- 3. Disconnect the power supply before installing or maintenance.
- 4. Make sure the wires have been properly connected before powering on the device.
- 5. Ensure the product has enough space for heat dissipation.
- 6. Ensure the luminaries are never covered by any heat insulation mat or slim layer material at anytime.
- 7. Suitable for damp locations.
- 8. Ambient Temperature: -20℃ to 45℃ , Aviod direct sunlight.
- 9. Storage Conditions: Cool & Dry conditions.

INSTALLATION PROCEDURE :







WARNING :

1. TURN POWER OFF BEFORE INSTALLATION.

2. TURN POWER BACK ON ONLY AFTER COMPLETE INSTALLATION AND EXAMINATION OF THE CIRCUIT.

CAUTION :

MAKE SURE THAT THE MOUNTING SURFACE OR STRUCTURAL MEMBER USED FOR INSTALLATION CAN SUPPORT THE WEIGHT OF STRIP LIGHT.

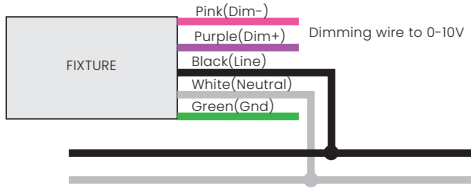
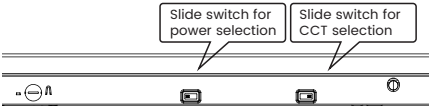
Package Contents	WIRE DIAGRAM
<div></div> <div>X1 for 4FT Cover Plates</div> <div></div> <div>X2 for 4FT Screw</div> <div></div> <div>X2 for 4FT Screw</div> <div></div> <div>X4 for 4FT Plastic Anchor</div> <div></div> <div>X2 for 4FT Suspension Cables</div> <div></div> <div>X2 for 4FT V-Hook</div>	<div></div> <div><h3>CCT & POWER SWITCH</h3><p>For the product with Slide Switch of CCT or power selection, please select the CCT or power needed before installation. (Ignore these steps if without the fuction)</p><div></div></div>

For Surface Mounting

1

Remove the wiring cover from the light fixture by sliding it in the direction of the arrow.

2

3

The Lens may drop out quickly!

Press and hold the Release Buttons on both sides of the Fixture Housing to release the Lens.

4

5

For V-Hook/Suspension Cables

Mounting Surface

Cables

V-Hook

①. Mount Cables to ceiling.

②. Connect Cables to V hanger.

③. Connect the wiring to the fixture as shown in wiring diagram.

④. Adjust the cables to achieve balance.